



# S.D. Mator

Published by ASPE San Diego Chapter #4

May 2019

Volume 17, Issue 9

## MEETING AT A GLANCE

**DATE:** TUESDAY, MAY 21, 2019

**TIME:** 4:15 PM—Registration Begins  
Networking

5:15 PM—Announcements  
Dinner Service Begins

6:00 PM—Program

**PROGRAM:**

**FUTURE REDEVELOPMENT  
OF SEAPORT VILLAGE**

**SPEAKER:**

**Yehudi “Gaf” Gaffen**

*Chief Executive Officer*

Gafcon, Inc. and Protea Waterfront

**DINNER LOCATION:**

**The Butcher Shop Steakhouse**

5255 Kearny Villa Road, San Diego, CA 92123  
Located east of Highway 163 and south of Clairemont Mesa Blvd

**Entrée choices:**

Tri-Tip Beef, Atlantic Salmon, or Mediterranean Pasta

**COST: Members & Guests – \$45/person**  
**Students (discount) – \$30/person**

*Cancellations must be received by NOON on  
Monday, May 20<sup>th</sup> or no shows will be billed.*

**RSVP:** <http://evite.me/8ynnR3X95G>



MEMBERS AND GUESTS UTILITIZING  
THE EVITE RESERVATION PLATFORM  
MUST PROVIDE THE INDIVIDUAL'S NAME AND  
COMPANY NAME FOR EVERY REGISTRANT.

—OR: Paul Chang CPE - 619.513.4399 (cell)  
[aspechapter4@outlook.com](mailto:aspechapter4@outlook.com)

## Seaport San Diego Develops Diverse Designs Enriching Local Opportunities and Global Tourism

by Lisa Thibodeaux, Construction Experts, Inc.  
ASPE San Diego Chapter #4 Programs Chair

Over the next six years, Seaport Village will transform from its aging, quaint presence into a 70-acre multi-use state-of-the-art construction program called *Seaport San Diego*. With 40 land acres and 30 water acres, San Diego's coastal profile will morph into a community and cultural hotspot with world-class amenities, educational opportunities, and outdoor activities. Its current reputation for unique small business retail experiences, and open outdoor space will expand to include the following world class features:

- San Diego Aquarium
- Education Center
- Spire (think Seattle Space Needle)

*(cont'd on pg.3)*

## INSIDE THIS ISSUE ...

May Program Article .....	1,3-4
Message from the Chapter President, Paul Chang, CPE .....	2
<b>Camp NAWIC thanks ASPE in a film clip!</b> .....	2
Camp NAWIC Opportunities for High School Girls <b>June 17-21</b> .....	2
Meet the New Members of Your Chapter: <b>Ryan Swenson</b> .....	5
Ask a CPE ... Q&A with <b>Dan Kilcoyne CPE</b> .....	6
ASPE San Diego Chapter #4 Scholarship Committee Announcement by <b>Dan Luckhardt CPE</b> .....	7
Spotlight on Member-Firms: <b>UNITED SITE SERVICES</b> .....	8
Become an ASPE Newsletter Sponsor or Advertiser .....	9
ASPE Membership, Mission Statement & Code of Ethics .....	9
San Diego Chapter Calendar of Events .....	10
2019 Officers, Board of Directors, Committees .....	11
Contact ASPE .....	11

**ATTACHMENTS:**

ASPE Chapter #4 Scholarship Application ..... [12-15](#)

**WHY ASPE?** — 3 Steps to Annual Renewal — Certificate

Programs + Online Classes — ASPE Career Center ..... [16-19](#)

## Message from the Chapter President by Paul M. Chang, CPE



Paul M. Chang CPE

Dear Friends and Members,

I would like to take this opportunity to thank everyone who came out to support our last ASPE Dinner Meeting for Seaport Village Redesigning the Entrance to San Diego with Gafcon, Chief Executive Officer, Yehudi Gaffen. The entire evening was truly enjoyable. ASPE appreciated the time, effort and skills of the guest speaker. The audience turnout was great and excited.

In today's construction market **Networking** often begins with a single point of common ground. The most obvious is a professional affiliation, but some people find effective networking opportunities in a college alumni group, a church or synagogue social group, or a private club.

For professionals, the best networking opportunities may occur at trade shows, events, seminars, and conferences, which are designed to attract a large crowd of like-minded individuals.

Networking helps a professional keep up with current events in the field and develops relationships that may boost future business or employment prospects. Needless to say, it also provides opportunities to help other people find jobs, make connections, and catch up on the news.

My Chapter Board of Directors and I look forward to welcoming you all at ASPE, an organization where you will not only polish your professional skills but also become a better Estimator.

Paul M. Chang, CPE



Camp NAWIC thanks ASPE  
for sponsoring their event!

Please [click here](#) for the film clip.

## Camp NAWIC Opportunities for High School Girls by Frank Young FCPE

**A** SPE San Diego Chapter #4 provides financial support for NAWIC's Camp NAWIC each year. This summer camp for high school girls, with an interest in design or construction, offers instruction in the basic trades for first-year campers (apprentices), and second-year or advanced campers (journeymen) undertake some type of building project (greenhouses, storage sheds, patio trellises, benches, doghouses, etc.) under the supervision of experienced professionals and college students acting as Project Managers.

**The camp runs from Monday, June 17<sup>th</sup> through Friday, June 21<sup>st</sup> at the AGC Training Center in San Diego.** The best part of the program is the cost to the campers – **entirely free of charge** due to industry sponsors and other fundraising efforts.

High school girls can make application to attend by going to the NAWIC Future Construction Leaders website. (Flyer [attached](#) to this newsletter.) Previously, we have had a few children of ASPE members sign up for this tremendous opportunity to explore your child's interest in design or construction.

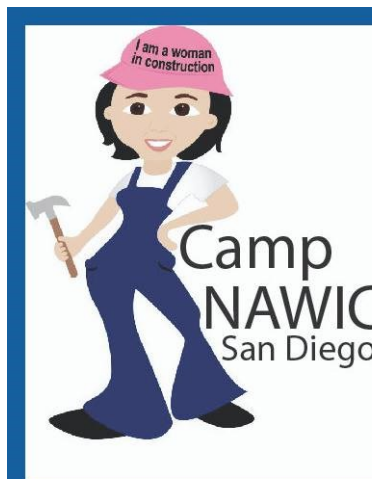

### Camp NAWIC 2019

June 17 - 21, 8am-4pm  
San Diego, CA 92121

Camp NAWIC is open to girls entering 9th grade and up interested in learning more about a career in construction.

# Seaport San Diego Develops Diverse Designs Enriching Local Opportunities and Global Tourism

[cont'd from pg 1](#)

- 5-Star Hotel
- Expanded Dock Space for boats of all sizes, including 450 ft. mega yachts
- Micro-Hotel
- Hostel
- Urban beach
- Outdoor gym
- Park
- Market
- and more

## 1HWY1's Master Plan

1HWY1 is the developer for the program and consists of Protea, managing partner, RCI Group, a waterfront developer, US ThrillRides, in charge of the Spire, OdySea out of Scottsdale, AZ in charge of the aquarium, and AECOM, a global engineering and design firm. The design team includes BIG, Bjarke Ingles Group, a Denmark-based architectural firm featuring architect Bjarke Ingels.

The mixed-use land and water development program is unprecedented. "Nothing like this has been done before in San Diego, but we feel good about the progress thus far and we're looking forward to all that's ahead," said Yehudi Gaffen, CEO of Gafcon, Inc. and Protea Waterfront.



Yehudi "Gaf" Gaffen

The Port of San Diego is also pleased with progress over three years since it first accepted Gafcon's proposal in 2016. Port Commissioner Dan Malcolm said, "The project components were bold, creative, compelling, iconic, dynamic and well thought out."

1HWY1 plans on dividing up the 70-acre space as follows:

- 276,000 sf for retail and restaurants is downsized from the current 400,000 sf retail space
- 1,933 hotel rooms dispersed across six different hotel brands
- 150,000 sf office space
- 2,200 parking spaces
- 14,000 lf of waterside dockage
- Slip space is projected to increase from 164 slips to 196 slips
- Fish processing plant projected 25,000 sf
- Veterans museum 75,000 sf
- Education/Learning Center 75,000 sf
- Aquarium + Butterfly Exhibit 192,050 sf
- Observation tower 80,000 sf extending 500 ft into San Diego's skyline
- Open space will cover over 70% of the program space

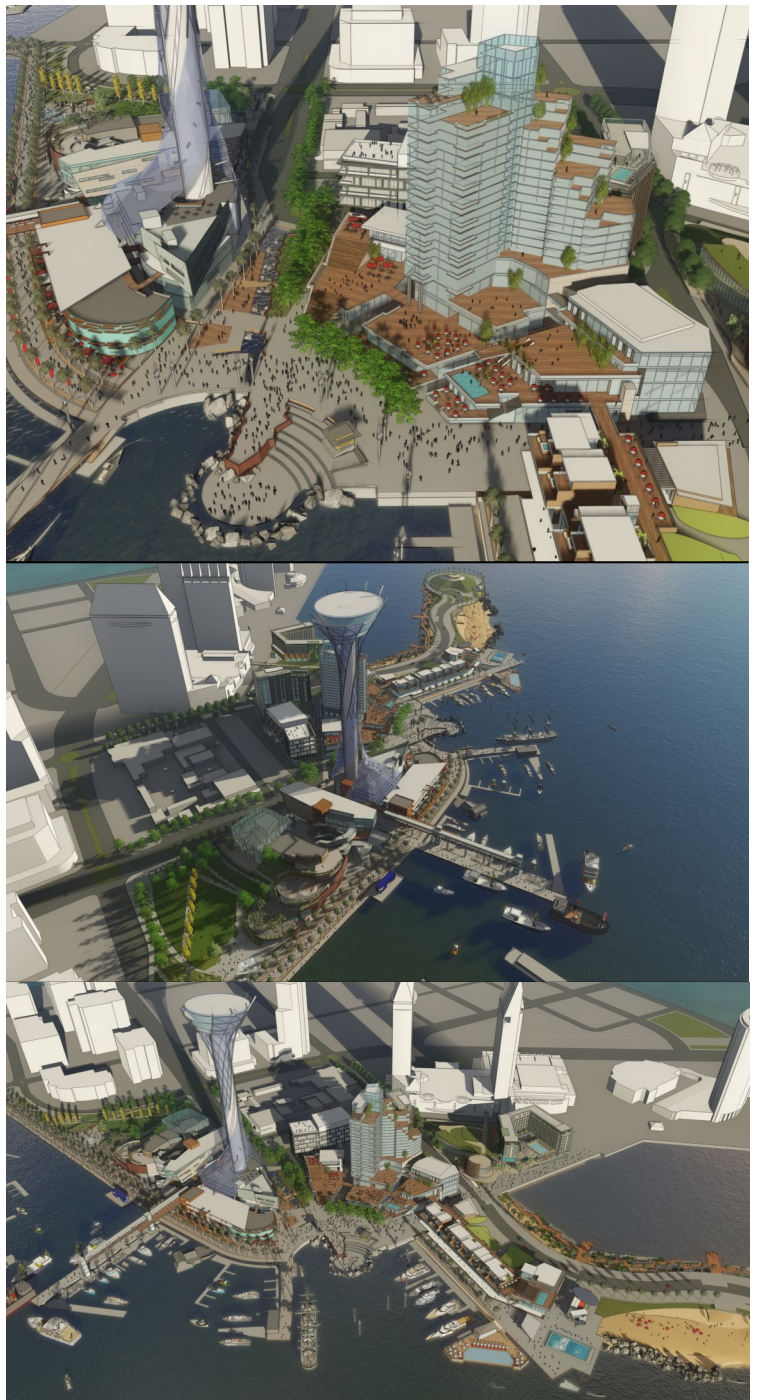

[\(cont'd on pg 4\)](#)

# Seaport San Diego Develops Diverse Designs Enriching Local Opportunities and Global Tourism

[cont'd from pg 3](#)

## Blue Campus

“Honoring the water” drives the Seaport San Diego vision. This can be seen in the many ways Gafcon, Protea, and 1HWY1 are working with the local fishing community, boat tourism opportunities, the Port of San Diego, and local educational institutions to ensure Seaport San Diego will offer sustainable fishing, educational, and commercial opportunities to its local and global visitors.

UCSD's Scripps Institution of Oceanography is partnering with the developer to provide an educational center for lifelong learning and research opportunities for San Diego students and researchers. The center's focus will include marine sciences, maritime logistics, and music.

“A 150,000 sf blue tech incubator for early-stage startups would act as an interface between academia and private industry” (*Big Changes to Seaport Village Plan*, SDUT, November 4, 2018).

## Tuna Harbor Upgrades

Tuna Harbor is home to San Diego's commercial fishing industry. Gaf wants to honor the San Diego fishing industry and plans on bringing needed amenities to enhance the infrastructure and bring in more consumer dollars to San Diego fishermen. Revitalization efforts include updating the docks and facilities, adding a dock and dine landing for The Fish House, and plans to create a sister facility at America's Cup Harbor including:

- a fish-processing facility
- A seafood market
- New berths for commercial fishing and aquaculture vessels

This is all good news for a coastal city that imports 90% of its seafood.

## An Overnight Stay for Every Budget

Gaf's plan for this outdoor city center is to include hotel stays for all budget types as seen in the inclusion of a hostel, micro-hotel, and 5-star world class hotel.

Micro-hotels can be seen in Japan and New York City where it is common to include more rooms in a smaller space that contrast with large expansive outdoor settings. A typical micro-hotel room is 50 sf, accommodating guests who are searching for economical, urban, trendy hotel stays in the center of the city.

The 5-star hotel may host aquarium-themed rooms featuring fishes swimming above or beside hotel rooms.

## Outdoor Activities for All Ages

Visitors will find a variety of outdoor activities at Seaport, including:

- Seaport San Diego Kids Zone where children can jump, splash, explore and create
- Yoga and tai chi platforms
- Beach volleyball courts
- Outdoor workout equipment
- Stationary cycling platforms
- Kayak and stand-up paddleboard rental and launch facilities
- A base camp building that will supply lockers, a juice and health food bar, and deck

## Infrastructure changes and earthquake fault lines

There are plans to extend Pacific Coast Highway and Kettner Boulevard to reconnect the city's burgeoning gem to downtown.

The active fault line that runs through the middle of the program area is a driver of program change. It also speaks to Gaffen's resilience and commitment to the project:

“It's not a show stopper by any means,” Gaffen said. “It's just the nature of where we live.”

**Join ASPE San Diego Chapter 4** as Yehudi “Gaf” Gaffen provides more insight, detail, and explanation of the Seaport's many features and facilities.

[\(cont'd on pg 5\)](#)

## Seaport San Diego Develops Diverse Designs Enriching Local Opportunities and Global Tourism

[cont'd from pg 4](#)

**Yehudi “Gaf” Gaffen** earned his BS in Construction Management from University of Cape Town, South Africa. In 1979 he moved to San Diego with his wife Pam after graduation and launched his career in management and construction. In 1987 Gaf and Pam founded Gafcon to fulfill his vision of assisting owners in *delivering complex projects and supporting vibrant communities*.

Gafcon has grown into a globally respected program and construction management consulting firm responsible for the success of hundreds of projects, including: the \$12B Zizhu Hi-Tech Park Development master plan in Shanghai; AltaSea, a \$135M adaptive reuse at the Port of Los Angeles; the City of San Diego North Embarcadero Visionary Plan; and the Port of Los Angeles Waterfront and Promenade. In 2016, the Unified Port of San Diego awarded the \$1.2B redevelopment of Seaport San Diego to Protea Waterfront Development, with Gafcon providing program management services. In 2018, Gafcon was selected to provide program management and consulting services for the San Diego County Regional Airport Authority’s Airport Design and Construction Program.

**The ASPE San Diego meeting will be held at Butcher Shop Steakhouse**, 5255 Kearny Villa Road, San Diego located east of Highway 163 and south of Clairemont Mesa Boulevard.

Topics to be covered include:

- Opening our waterfront with a world-class urban resort district
- Combining commercial space, office space, open space and the blue economy
- Showcasing the water’s edge, providing the signature experience of Seaport San Diego
- Including vibrant places to shop, taste, and learn that will awaken our waterfront

Registration begins at 4:15 PM – Networking 4:15-5:15 PM

Announcements begin at 5:15 PM

Dinner service 5:15 PM – Presentation 6:00 PM

Meal choices: Tri-Tip Beef, Atlantic Salmon, Mediterranean Pasta    Cost: Members & Guests \$45 – Students \$30

There is much more to learn about this project, its redesign, and plans for the future. "2019 will be an important year for Seaport," Gaffen said. "We will be validating the current design and begin testing concepts to see what San Diegans prefer to do and see at our waterfront."

Come be a part of the conversation that reveals the Seaport San Diego of the future.

Meeting at a glance information can be found on [page 1](#).

Lisa Thibodeaux, Construction Experts, Inc.  
ASPE San Diego Chapter #4 Programs Chair

## Meet the New Members of Your Chapter — Focus on ... RYAN SWENSON - Territory Manager, Simpson Strong-Tie



Ryan Swenson

**R**yan joined Simpson Strong-Tie in 2006 as a Retail Specialist tasked mainly with setting up new retail locations and assisting the National Accounts Manager at the Stockton location. He transitioned into the Dealer Sales position covering lumberyards in the East Bay following Highway 101 North to Oregon.

In 2011, Ryan took over the role of Territory Manager of the Northern Nevada and Lake Tahoe area. In October of 2018, Ryan relocated to San Diego as the Territory Manager.

Ryan is very active in the building community and is an active member of many trade associations. Ryan enjoys every aspect of his job, especially working with Engineers, Building Department and getting out to the Jobsites. ■

# Ask a CPE: Q & A

Responses from Dan Kilcoyne, CPE—California Sheet Metal

---



*Dan Kilcoyne CPE*

**1. When did you complete the CPE certification?**

I completed my certification in September 2018.

**2. What made you pursue CPE certification?**

I wanted to take more seriously my proficiency within Estimating.

The certification process gave me the opportunity to demonstrate current competencies, and was also invaluable in revealing where I needed further development.

**3. What would you say the benefits are of having the CPE certification?**

Regardless of where I work, it seemed fitting to have independent recognition of my standing within the Estimating Community. In return for the effort, certification has afforded me confidence in my current position and optimism in my career moving forward.

**4. What do you suggest to other estimators regarding getting certified?**

I would say anyone who has chosen Estimating as their career should strongly consider going through the CPE process. While challenging, even those with numerous other obligations can successfully achieve certification. Many within ASPE are available to help you through the process as well.

**5. Brief description of your certification process, estimating life and/or any other comments?**

In April 2018 I started the CPE certification process. Maintaining a balance with family life, career responsibilities, and certification studies extended the completion until September 2018. Through the help of several fellow ASPE members, I was able to write an accepted Technical Paper, and pass the General Knowledge and Discipline Specific exams. I can honestly say that going through the certification process was well worth the result.

---

If you have any questions, please contact Dan Kilcoyne CPE ([dan@kilcoyne.me](mailto:dan@kilcoyne.me)).

# American Society of Professional Estimators Chapter #4 Scholarship Committee Announcement



by Daniel Luckhardt, CPE

On behalf of The American Society of Professional Estimators Scholarship Committee, I am pleased to announce the acceptance period for the '2019 Scholarship Application.' Our mission statement is as follows:

**Mission Statement:** *"The American Society of Professional Estimators serves construction estimators, by providing education, fellowship and opportunity for professional development."*

**Our Vision:** *"In its educational pursuits, ASPE strives to be the recognized leader in providing quality programs to benefit the cost estimating profession and the construction industry."*



Dan Luckhardt CPE

*San Diego Chapter #4's Scholarship Awards are designed to promote student involvement in chapter affairs, and to reward deserving students who exhibit a sincere interest in education and the construction industry, as demonstrated by their work experience and personal statements.*

As ASPE members and individuals affiliated with our profession, it is my hope we raise the bar this year and simply get the word out to qualified candidates. Please take the time to reach out to professionals in our industry. These individuals may be working professionals or full-time students currently enrolled within an educational institution with aspirations of working within the construction industry. Please refer to the Scholarship 'Eligibility' requirements within the Scholarship Application, and or feel free to contact Daniel Luckhardt, Scholarship Committee Chairman, by e-mail or phone (noted below).

## Recommendations to applicants:

- ✓ Submission deadline: **Monday, June 10, 2019**. Please refer to the application instructions.
- ✓ Eligibility requirements: Please review the requirements and feel free to ask questions early in the application preparation process.
- ✓ Application: Please allow time in your schedule to solicit letters of recommendations.

As part of our monthly newsletter, you will find the 'Eligibility, Requirements, and the Application' [attached](#) in a PDF format. Again, on behalf of the Scholarship Committee, we look forward to receiving and reviewing applications for Scholarship Award considerations.

Good luck!

## Daniel Luckhardt, CPE

Swinerton Builders

Scholarship Award Committee Chairman

[dluckhardt@swinerton.com](mailto:dluckhardt@swinerton.com)

949.343.6309



## Our Story



United Site Services is the nation's leader in the portable toilet and temporary fence rental services. With more than 90 locations coast to coast and the largest fleet of portable sanitation equipment, it is no wonder why United Site Services is trusted by more top industry professionals than any other temporary site service provider. Our wide selection of solutions, products, and our fast, courteous customer service provides peace of mind during all phases of your project or event.





# Become an ASPE Newsletter Corporate Sponsor or Advertiser

---

## **CORPORATE SPONSOR—\$400/yr Includes following benefits:**

- **Sponsor Recognition in 12 Monthly Newsletters and on Chapter Website, GIFS Wheel**
- **Full-Page Sponsor Profile in 1 Issue**
- **Hot Link to Sponsor's Website or Designed Email Address**

## **INDIVIDUAL BUSINESS CARD AD—\$200/yr**

### **EMPLOYMENT AD:**

**\$70 /ad in 1 issue; \$100/ad on website  
FREE TO ASPE MEMBERS!**

### **FOR MORE INFO—CONTACT:**

**Treasurer: FRANK YOUNG FCPE**  
Cell 619.980.4025; [pancho77@cox.net](mailto:pancho77@cox.net)

**P.R. Chair: JOE HERNANDEZ**  
619.717.1814;  
[joehernandez777@yahoo.com](mailto:joehernandez777@yahoo.com)



## **ASPE MISSION STATEMENT**

**The American Society of Professional Estimators**  
is dedicated to the promotion of  
the profession of estimating and to  
the benefit of the construction industry.

[Click here](#) for ASPE's **CODE OF ETHICS.**

## **ASPE Membership**

**A**n accurate cost estimate is the first of many key components of a successful construction project. Plan interpretation, labor and material costs, scheduling costs, and level of difficulty recognition are a fraction of the skills necessary to become a successful estimator.

Why join the American Society of Professional Estimators? ASPE is the most recognized and credentialed group of construction cost professionals in our nation's construction industry. ASPE provides education, industry information, and fellowship to all levels of our members. It is made up of professionals in the following three member classifications.

- 1- **Estimator:** Shall be an active Construction Estimator in one or more of the construction estimating disciplines.
- 2- **Affiliate Member:** Shall be employed in a construction-related field.
- 3- **Student:** Shall be a full-time student actively pursuing a curriculum leading to a degree or certificate in a construction-related field.

One of the ultimate goals of a member in ASPE is to achieve status as a "Certified Professional Estimator," otherwise known as "CPE." CPE status is recognized by Builders, Government Agencies, [joehernandez777@yahoo.com](mailto:joehernandez777@yahoo.com)

Developers, and many other Corporate entities as the highest level of qualification as an estimator. Educational training is available to become part of this elite group of professionals.

ASPE San Diego Chapter #4 is perennially recognized as one of the top chapters of the nation's 50 chapters. The local chapter meets on the third Tuesday of each month. This general membership meeting offers education and insight into our industry. Each membership meeting is highlighted by presentations and guest speakers, with information pertinent to our ever-changing industry.

If you would like to become part of this exciting group of professionals, please contact Venu Dorapally CPE at 858.947.5197 or:

[venuarch@gmail.com](mailto:venuarch@gmail.com)

# San Diego Chapter #4 Calendar of Events



◆ **Tuesday, May 21, 2019 (4:15 PM Registration)**

**ASPE San Diego Monthly Dinner Meeting**

**Program:** Future Redevelopment of Seaport Village

**Speaker:** Yehudi "Gaf" Gaffen, CEO  
GAFCON, Inc.

**Location:** The Butcher Shop  
5255 Kearny Villa Road, San Diego

◆ **Tuesday, June 4, 2019 (5:30-7:30 PM)**

**ASPE San Diego Monthly Board Meeting**

**Location:** Offices of Balfour Beatty  
10620 Trenea Street, Ste 300, San Diego  
(East of I-15, South of Mira Mesa Blvd)

◆ **Tuesday, June 11, 2019 (4:15 PM Registration)**

**NOTE REVISED MEETING DATE TO SECOND TUESDAY ... ONE WEEK EARLIER THAN USUAL**

**ASPE San Diego Monthly Site Tour Dinner Meeting**

**Tentative Program:** Office Tour and Presentation  
on Cost Estimating

**Office Tour Hosts/Speakers:** Representatives from  
Cumming Corporation

**Location:** 15015 Avenue of the Sciences, Ste 160  
San Diego (Carmel Mountain)

**Dinner Venue:** Catered Dinner by  
Rubio's Coastal Grille

◆ **Wednesday-Saturday, June 19-22, 2019**

**ASPE Annual Meeting and Estimating Summit**

**Location:** Doubletree Hotel by Hilton Kansas City  
10100 College Blvd, Overland Park, KS 66210

◆ **Tuesday, June 25, 2019 (5:30-7:30 PM)**

**ASPE San Diego Monthly Board Meeting**

**Location:** Offices of Balfour Beatty  
10620 Trenea Street  
Ste 300, San Diego  
(East of I-15, South of Mira Mesa Blvd)

◆ **Tuesday, July 16, 2019 (4:15 PM Registration)**

**ASPE San Diego Monthly Dinner Meeting**

**Program:** To be determined

**Speaker:** To be determined

**Location:** To be determined

◆ **Tuesday, July 30, 2019 (5:30-7:30 PM)**

**ASPE San Diego Monthly Board Meeting**

**Location:** Offices of Balfour Beatty  
10620 Trenea Street  
Ste 300, San Diego  
(East of I-15, South of Mira Mesa Blvd)



# Directory of San Diego Chapter #4 Officers and Directors



**TECHNICAL COMMITTEES:**

**Certification:**  
Dan Kilcoyne, CPE

**Education:**  
Steve Schraibman, CPE

**Standards:**  
OPEN

**STANDING COMMITTEES:**

**Chapter Awards**  
Frank Young, FCPE

**National Awards**  
OPEN

**Nominations:**  
OPEN

**Communications—  
Website:**  
Paul Chang, CPE

**Communications—  
Newsletter:**  
Alicia Kovacs

**Finance:**  
Frank Young, FCPE

**Ways & Means:**  
David Luhm, E

**Public Relations/  
Calendar:**  
Joe Hernandez, E

**Membership:**  
Venu Dorapally, CPE

**Programs:**  
Lisa Thibodeaux

**OTHER COMMITTEES:**

**Ethics:**  
Dan Luckhardt, CPE

**Mentoring:**  
Frank Young, FCPE

**Scholarships:**  
Dan Luckhardt, CPE

**Outreach:**  
Paul Chang, CPE

## 2019-20 Chapter Officers

Office	Officer	Phone	Fax	Email
<b>President</b>	Paul Chang, CPE Balfour Beatty	858.635.7464 619.513.4399-C		<a href="mailto:aspechapter4@outlook.com">aspechapter4@outlook.com</a>
<b>1<sup>st</sup> Vice-President</b>	Steve Schraibman, CPE Arcor-Inc.	858.481.4494 619.252.4941-C	858.481.4146	<a href="mailto:steve@arcor-inc.com">steve@arcor-inc.com</a>
<b>2<sup>nd</sup> Vice-President</b>	Dan Luckhardt, CPE Swinerton Builders	619.291.4600 858.342.8017-C		<a href="mailto:dluckhardt@swinerton.com">dluckhardt@swinerton.com</a>
<b>3<sup>rd</sup> Vice-President</b>	OPEN			
<b>Secretary</b>	David Luhm, E Countywide Mechanical	760.238.3355-C		<a href="mailto:dluhm@countywidems.com">dluhm@countywidems.com</a>
<b>Treasurer</b>	Frank E. Young, FCPE Ramos Consulting Svcs	619.440.5517 619.980.4025-C	619.401.7545	<a href="mailto:pancho77@cox.net">pancho77@cox.net</a>
<b>Immediate Past President</b>	Michael Moyers, CPE Best Interiors, Inc.	858.737.7316 619.843.6962-C	858.737.7317	<a href="mailto:michael.moyers@bestinteriors.net">michael.moyers@bestinteriors.net</a>
<b>Executive Administrator</b>	Margy Ashby	619.749.1890 619.302.3257-C	619.839.3817	<a href="mailto:info@aspechapter4.org">info@aspechapter4.org</a> <a href="mailto:asped4@gasvcs.net">asped4@gasvcs.net</a>

## 2019-20 Chapter Board of Directors

Director	Phone	Fax	Email
Venu Dorapally, CPE Kitchell Contractors, Inc.	858.947.5197		<a href="mailto:venuarch@gmail.com">venuarch@gmail.com</a>
Joe Hernandez, E Kitchell Contractors, Inc.	619.717.1814		<a href="mailto:joehernandez777@yahoo.com">joehernandez777@yahoo.com</a>
Dan Kilcoyne, CPE California Panel Systems	619.562.7010		<a href="mailto:dan@calpanelsystems.com">dan@calpanelsystems.com</a>
Alicia Kovacs Nielsen Construction Ca.	619.820.3057-C	619.795.0042	<a href="mailto:akovacs@nielsencc.com">akovacs@nielsencc.com</a>
Tori Penland United Site Services Inc.	760.705.9728 x59728 760.443.0754-C		<a href="mailto:victoria.penland@unitedsiteservices.com">victoria.penland@unitedsiteservices.com</a>
Lorena Quintero Willscot	619.710.8468 x44403 619.787.1693-C		<a href="mailto:lorena.quintero@willscot.com">lorena.quintero@willscot.com</a>
Edna Rodriguez Herc Rentals Inc.	877.690.8365 858.253.9421-C		<a href="mailto:edna.rodriguez@hercrentals.com">edna.rodriguez@hercrentals.com</a>

### CONTACT ASPE SAN DIEGO CHAPTER

Phone: 619.749.1890 Email: [info@aspechapter4.org](mailto:info@aspechapter4.org)

Chapter Website: [aspechapter4.org](http://aspechapter4.org) National Website: [aspenational.org](http://aspenational.org)



AMERICAN SOCIETY  
OF PROFESSIONAL  
ESTIMATORS  
SAN DIEGO CHAPTER #4

**2019  
UNDERGRADUATE COURSES  
SCHOLARSHIP PROGRAM**

**Eligibility, Requirements, Awards  
and Application**

**Submission Deadline:**

Applications and Reference Letters must be mailed to the ASPE San Diego Chapter #4 Scholarship Committee and postmarked on or before **Monday, June 10, 2019**.

**Mail to:**

ASPE San Diego Chapter #4 Scholarship Committee  
c/o Dan Luckhardt CPE  
Swinerton Builders  
17731 Mitchell North, Suite 200  
Irvine, California 92614-6028

**If you have questions, please contact:**

ASPE San Diego Chapter #4 Scholarship Committee  
Daniel Luckhardt  
[dluckhardt@swinerton.com](mailto:dluckhardt@swinerton.com) or (949) 343.6309



Mission Statement: "The American Society of Professional Estimators serves construction estimators by providing education, fellowship and opportunity for professional development."

Our Vision: "In its educational pursuits, ASPE strives to be the recognized leader in providing quality programs to benefit the cost estimating profession and the construction industry."

San Diego Chapter #4's Scholarship Awards are designed to promote student involvement in chapter affairs, and to reward deserving students who exhibit a sincere interest in education and the construction industry, as demonstrated by their work experience and personal statements.

### **ELIGIBILITY**

1. Applicant may be currently taking undergraduate accredited courses.
2. Applicant must be employed in the construction industry, preferably working for an ASPE Member-Firm.

### **REQUIREMENTS**

1. Applications must be submitted in hardcopy/original format.
2. Applicant is responsible for ensuring that all items listed below are included in the submittal package and postmarked on or before **Monday, June 10, 2019**.
  - a) Completed and signed application.
  - b) Personal statement.
  - c) Letters of recommendation.
3. Applicant must be able to attend ASPE San Diego Chapter #4's Awards Dinner on Tuesday, July 16, 2019 between the hours of 5:30 p.m. and 8:30 p.m. at a location to be determined in general San Diego area.

### **AWARDS**

1. A scholarship in the amount of \$500.00\* will be awarded.
2. Applications will be reviewed by the ASPE San Diego Chapter #4 Scholarship Committee. Attention and consideration will be given to work experience; applicant's expressed interest in furthering his/her education, goals in the construction industry, and references.
3. Designees will be notified by Monday, June 24, 2019.
4. Award will be made and check distributed during the Awards Dinner.

Non-Discrimination Clause:

The American Society of Professional Estimators is an Equal Opportunity Organization and encourages applications from all individuals.

\*The amount of the scholarship is subject to change.



## 2019 SCHOLARSHIP APPLICATION

Please limit application form to 3 pages and restrict your personal statement to 2 pages.

### PERSONAL INFORMATION

Name

---

Address

---

City, State, Zip

---

Telephone \_\_\_\_\_ E-Mail \_\_\_\_\_

I would like to be contacted about internship opportunities with ASPE Member-Firms.

### SCHOLASTIC INFORMATION

List of ASPE Online Courses already taken by applicant:

---

---

Previous College or University education:

---

City, State:

---

Area of concentration: \_\_\_\_\_

Degree anticipated: \_\_\_\_\_



**2019 SCHOLARSHIP APPLICATION**

Professional or School Affiliations (List participation in any school, professional or community activities including offices held and awards received):

---

---

---

**EMPLOYMENT HISTORY**

Work Experience: (List full-time, part-time, co-op and summer employment. Briefly describe duties and responsibilities.)

---

---

---

**RECOMMENDATION**

Letters of recommendation from ASPE member or job supervisor with personal knowledge of the applicant must accompany the application (maximum 2 letters).

**PERSONAL STATEMENT**

A statement about your career goals and why you think you should receive the scholarship award. Include information about:

- Your career objectives
- How you and the construction industry can benefit each other
- Your most important extracurricular activity

Statement should not exceed 500 words or (2) pages. Please attach to application form.

*I agree that the application and all attachments may be used for the purposes of evaluation and selection by the ASPE San Diego Chapter #4 Scholarship Committee.*

Signature: \_\_\_\_\_ Date: \_\_\_\_\_

**APPLICANT: You have the responsibility to ensure that the application, all forms, letters are postmarked on or before **Monday, June 10, 2019** and received by the ASPE San Diego Chapter #4 Scholarship Committee.**



AMERICAN SOCIETY  
OF PROFESSIONAL  
ESTIMATORS  
SAN DIEGO CHAPTER #4



# WHY ASPE?

## The Professional Network and Thought Leadership of Estimators worldwide.

The American Society of Professional Estimators serves residential, commercial and civil construction estimators by providing Education, Fellowship, and the opportunity for Professional Development. The proper Education, Ethics, Standards, Certification and Fellowship lead to the ultimate goal of Professionalism.



Share, Collaborate, Exchange and Grow.

*If you submit numbers on bid day,  
then you belong in ASPE.*

**JOIN ASPE TODAY!**

**ASPE CORE VALUES**

**EDUCATION**

**PROFESSIONALISM**

**FELLOWSHIP**

**ASPE SAN DIEGO  
CHAPTER # 4**

[www.aspechapter4.org](http://www.aspechapter4.org)





# 3 Steps to Annual Renewal

## Step 1 = PDUs

Professional Development Units must be earned + logged within the calendar year. Submit documentation, in PDF or DOC format, to back-up journal entry.

**CPE = 24 PDUs**  
**AEP = 12 PDUs**

To access the PDU Journal, sign into your ASPE Profile. PDU Reference Table found on the Certification page.

**CPE** = Certification > CPE Applications + Forms > More Information  
**AEP** = Certification > Certification Program (AEP) > More Information

## Step 2 = Application

Certificate holders are required to complete the Renewal Application from within their profile.

**CPE** = Certification > CPE Applications + Forms > More Information  
**AEP** = Certification > Certification Program (AEP) > More Information

## Step 3 = Fees

**Renewal Fees** are paid within the online application, available at [ASPEnational.org](http://ASPEnational.org) / Certification.

**CPE + AEP Renewal Fees**  
ASPE Member = \$ 50  
Non-Member = \$350



Certification Cycle = January 1 – December 31





## Certificate Programs + Online Classes

### *Certificate Programs*

Construction Estimating

Civil Sitework Construction

Construction Supervision - Civil Sitework

Construction Supervision

Construction Practices

Construction Project Management

Construction Supervision - Building

### *Self-Paced Courses*

101 Introduction to Construction Estimating

102 Essential Construction Math

### *Instructor-Guided Courses*

103 Construction Blueprint Reading

201S Leadership + Motivation

105 Estimating + Bidding 1

202 Oral + Written Communication Skills

106 Estimating + Bidding 2

203P Problem Solving + Risk Management

107 Construction Materials + Processes

204 Contract Documents + Construction

108 Construction Equipment + Methods

205T Planning + Scheduling

109 Practical Applications of Civil Sitework

206T Construction Productivity + Cost Management

110 Civil Blueprint Reading + Materials

305 Building Green Buildings

114 Estimating Civil + Sitework Construction

308 Construction Project Management

Courses begin in January, April, June and September \* Each Course is a 10-Week Session

*Visit ...*

**ASPEnational.org / Education / Certificate Programs or Online Classes**

for the following Class Information

Fees • Prerequisites • Learning Objectives • Class Organization + Grading • Weekly Syllabus

Assistance is available by contacting

Cinder, Online Class Coordinator • 615.316.9200 • Cinder@ASPEnational.org

**As an ASPE Member, you will enjoy discounted Class Fees !**

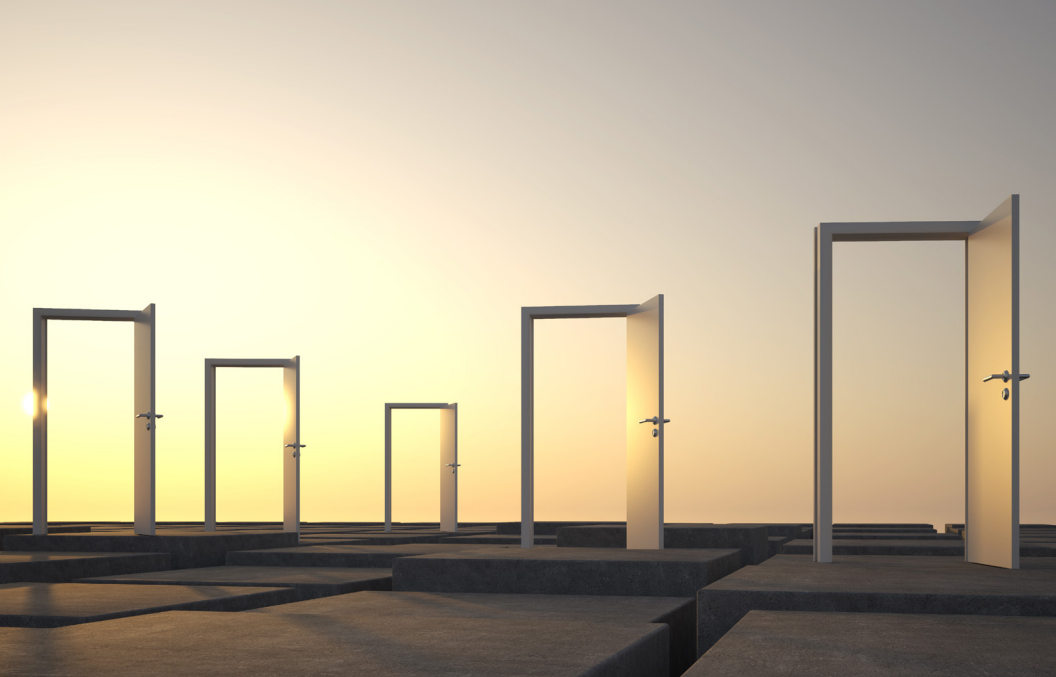

## Search for quality candidates on ASPE Career Center

### **ASPE will allow you to:**

- Post your job in front of the most qualified group of industry professionals
- Promote your jobs directly to candidates via the exclusive Job Flash email
- Search the anonymous resume database to find qualified candidates
- Manage your posted jobs and applicant activity easily on our user-friendly site

**Start your search today by visiting**  
**[ASPEnational-jobs.careerwebsite.com](https://www.aspenational-jobs.careerwebsite.com)**



**AMERICAN SOCIETY  
OF PROFESSIONAL  
ESTIMATORS**

# CALLING ALL GIRLS Grades 8-12

## Hands-on Construction Camp

**JUNE 17—June 21, 2019**

**8am—4pm**



at: Associated General Contractors  
Apprenticeship Training Facility  
6212 Ferris Square, SD 92121

The National Association of Women in Construction is ramping up for Camp NAWIC 2019. Join us for a FREE, week-long summer day camp.

Attendees have the opportunity to build take-home projects from the lessons in carpentry, electrical, solar energy, plumbing, and sheet metal. Operating heavy construction equipment and surveying are two of the favorite activities! Ladies, have fun with your friends for a whole week!

At graduation on Friday, you and your parents are invited for a barbeque lunch and a grand celebration!

**Learn more/Register at <http://bit.ly/CampNAWIC>**

